

NO	REVISION	DATE	CHK.	APP.
△				

- * SPECIFICATION
1. APPLICABLE FLUID : STEAM
 2. WORKING PRESSURE : Max. 16 kgf/cm²
 3. WORKING TEMPERATURE : MAX. 220°
 4. HYDRO. TEST PRESSURE : WORKING PRESSURE x 1.5
 5. END CONNECTION : JIS B 0203 PIPE TAPER THREAD
 6. PAINTING : HEAT RESISTANCE SILVER COLOR

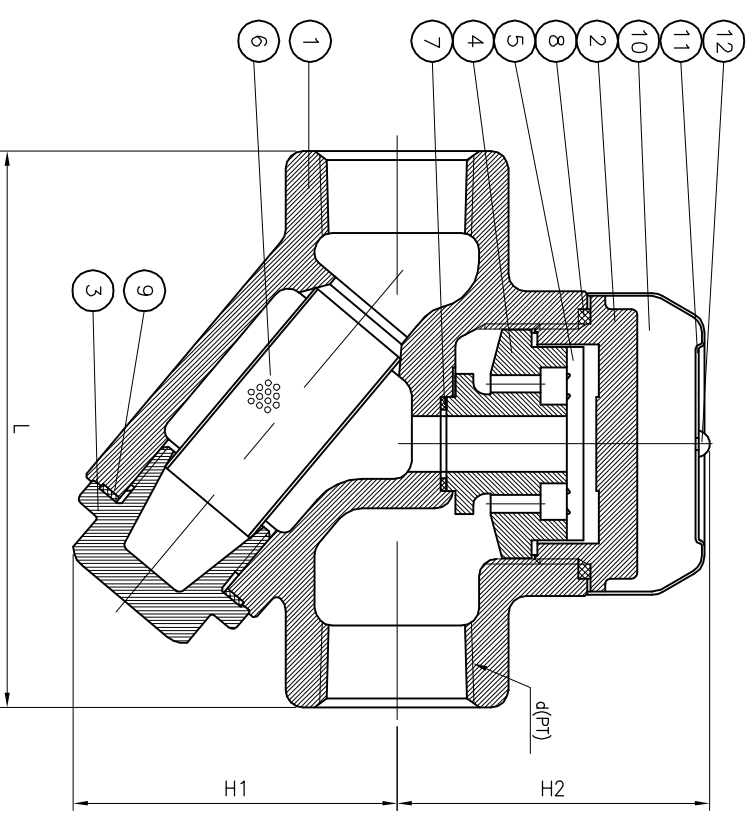

* DIMENSIONS

VALVE NO.	SIZE	CHK.	L	H1	H	d(PT)	WEIGHT(kg)	Q'TY
	15A		90.0	56.0	52.0	1/2"	0.5	
	20A		95.0	56.0	52.0	3/4"	0.5	
	25A		100.0	61.0	52.0	1"	1.0	

unit : mm

NO.	PART NAME	Q'TY	MATERIAL	REMARK
12	RIVET	1	AL	
11	NAME PLATE	1	SUS304	
10	INSULATION CAP	1	SUS304	
9	PLUG GASKET	1	NON-ASBESTOS	
8	CAP GASKET	1	PTFE	
7	SEAT GASKET	1	PTFE	
6	SCREEN	1	SUS304	
5	DISC	1	SUS420 J2	
4	SEAT	1	SUS410	
3	PLUG	1	SC480	
2	CAP	1	SCS13	
1	BODY	1	FDD450	

TITLE	TYPE	DISC	SIZE	15A-25A	MODEL NO.
STEAM TRAP					TDC-1S

DWN.	LEE.A.N	DATE	UNIT	SCALE	DWG. NO.
CHK.	PARK.H.G	2011.06.01	mm	N/S	YTDC-3S-U01
APP.	KIM.D.H				



YOYOUN CO., LTD.